

ISOMETRIC VIEW

NOTE:
NAIL BASE INSULATION SHALL BE TRIMMED BACK FROM RAKE EDGE AND EAVE TO ACCOMMODATE RAKE AND EAVE NAILERS. OSB SHALL BE SUPPORTED ON RAKE EDGE AND EAVE BY WOOD NAILER.

1 NAILBASE FASTENING DETAIL AT RAKE EDGE
A3.6 NTS

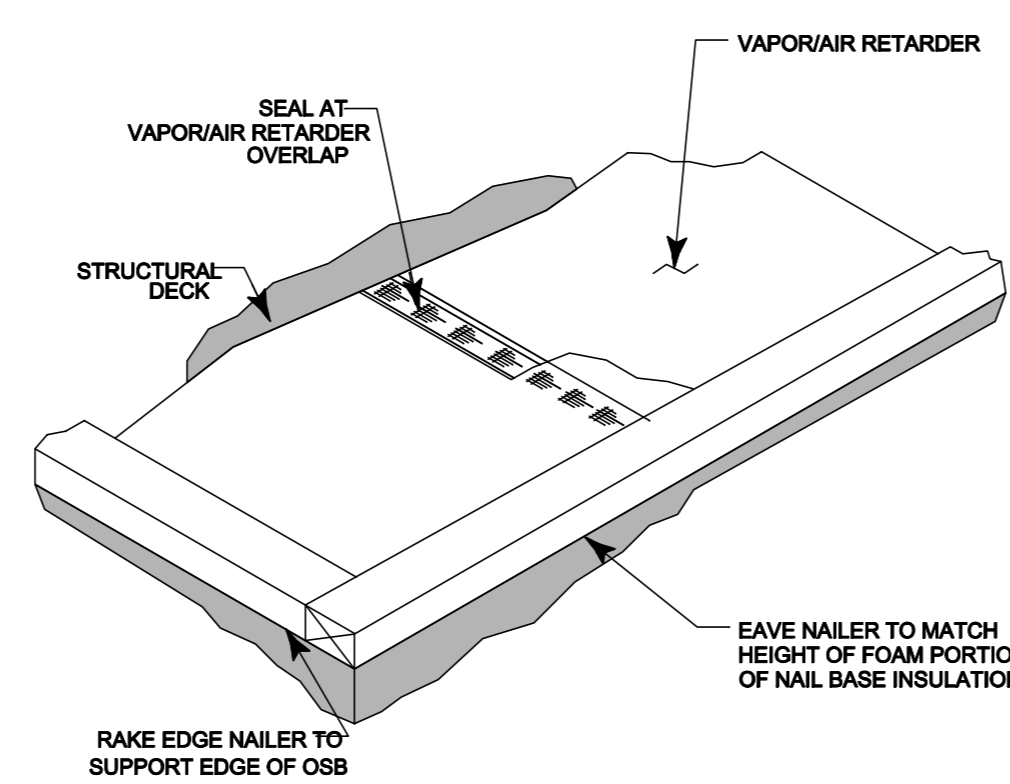

ISOMETRIC VIEW

NOTES:
1. A SUITABLE VAPOR RETARDER SHALL HAVE A MINIMUM PERM RATING OF 0.5 OR LESS AS DETERMINED BY ASTM E 96.
2. FOLLOW VAPOR/AIR RETARDER MANUFACTURER'S INSTALLATION INSTRUCTIONS FOR SEAMING AND PERIMETER EDGE TERMINATIONS.

2 NAILBASE VAPOR RETARDER DETAIL
A3.6 NTS

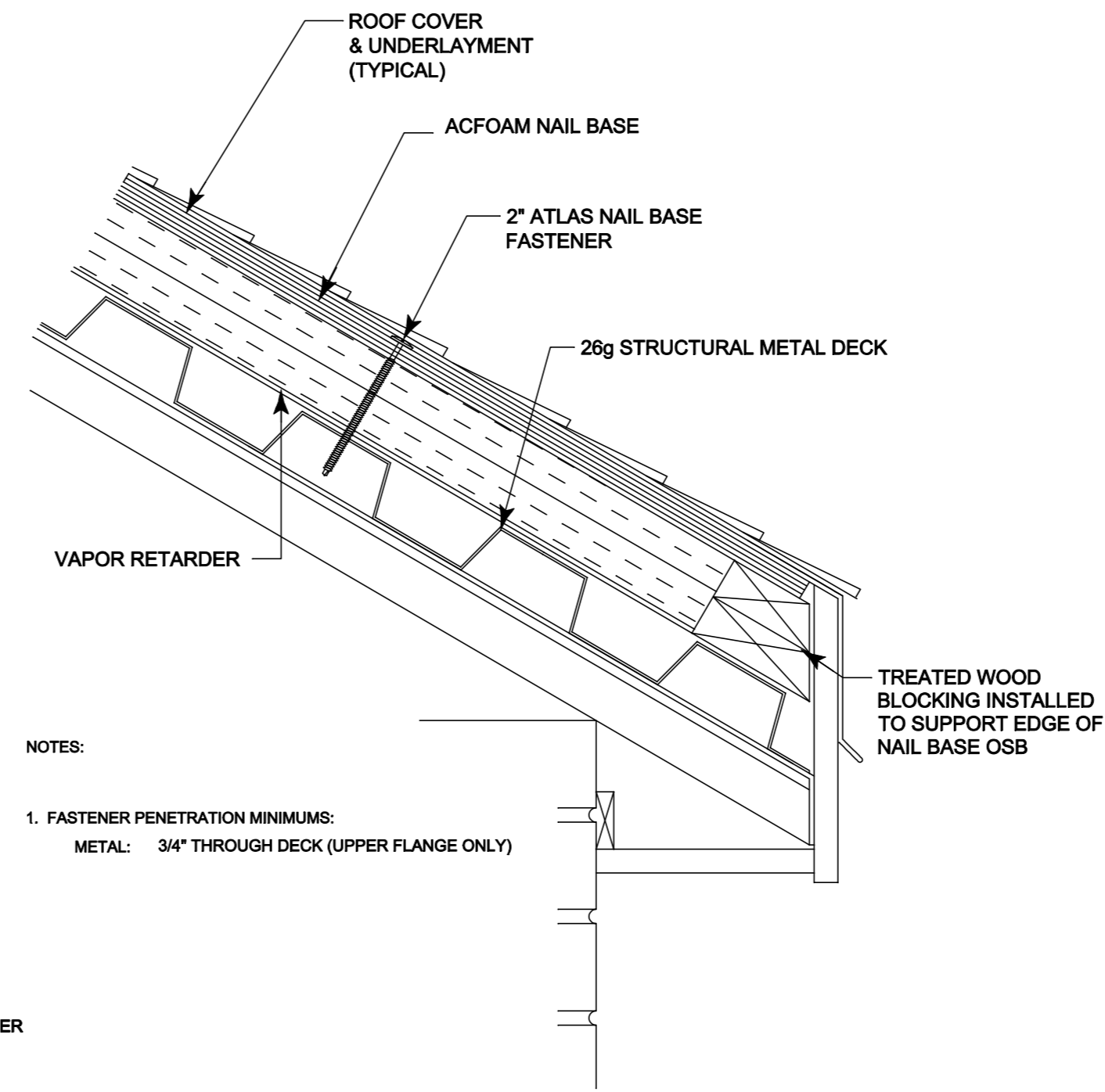

NOTES:
1. FASTENER PENETRATION MINIMUMS:
METAL: 3/4\"/>

3 NAILBASE EAVE DETAIL
A3.6 NTS

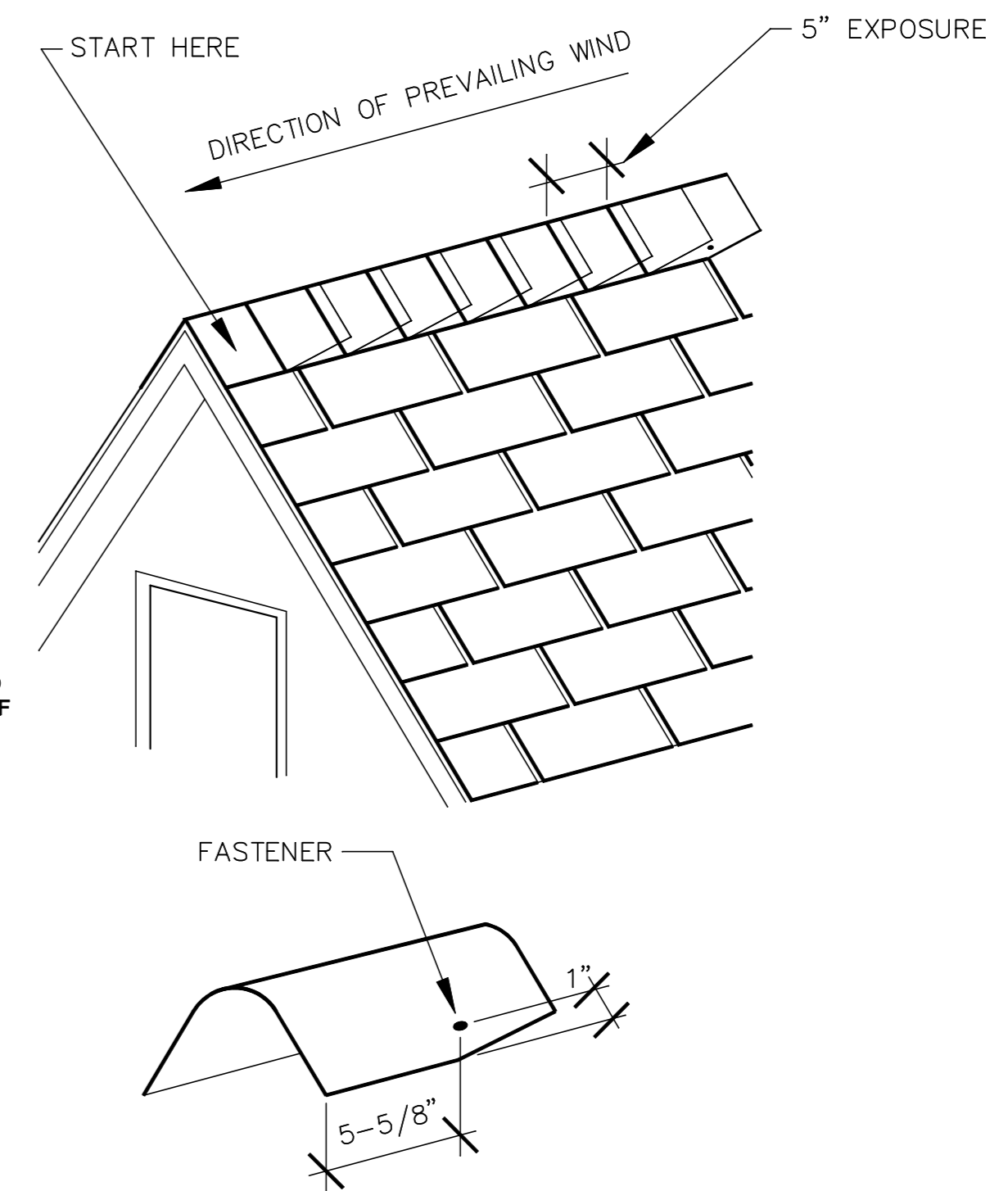

4 RIDGE DETAIL
A3.6 NTS

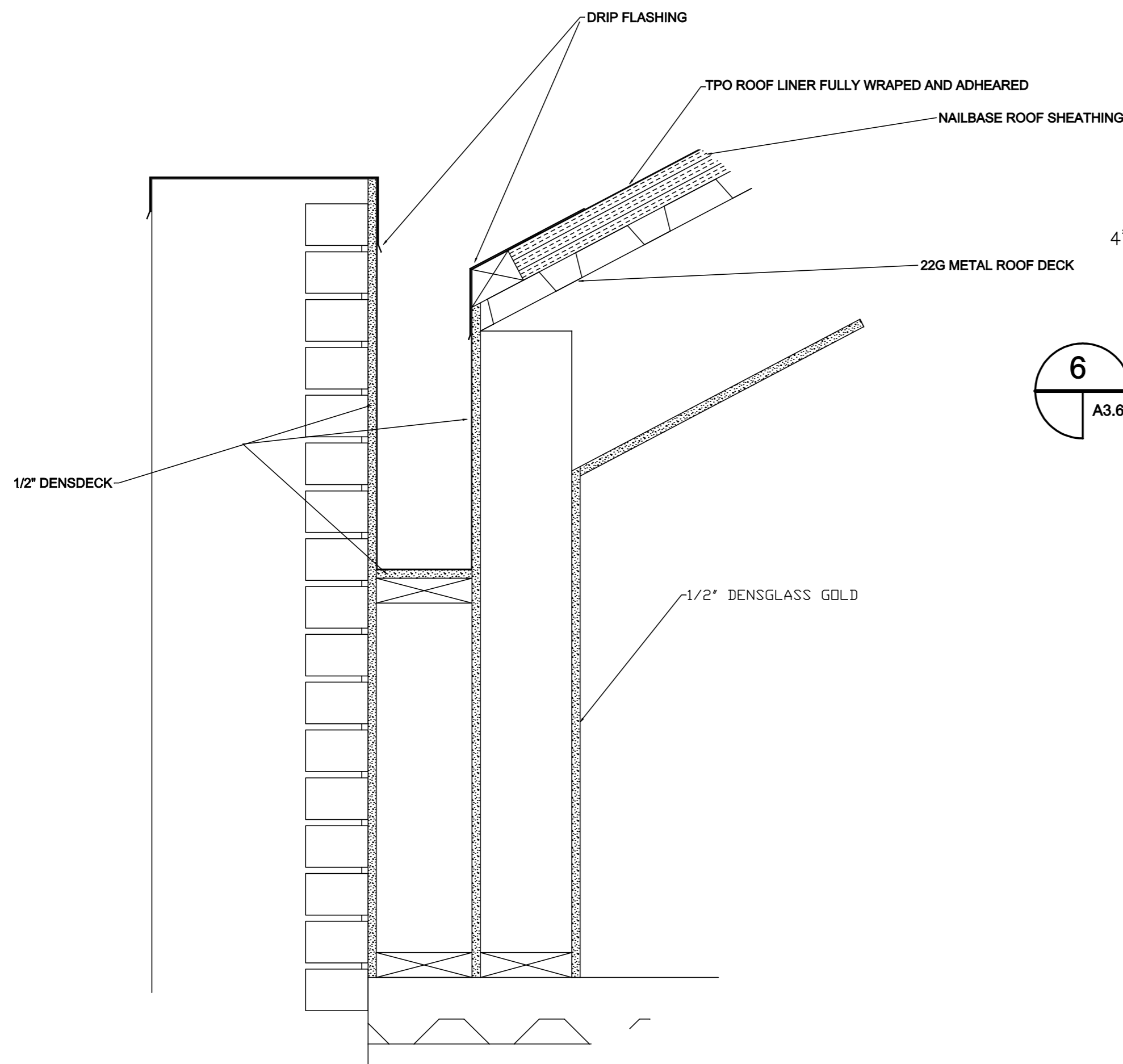

5 INTERIOR GUTTER DETAIL
A6.3 A3.6 NTS

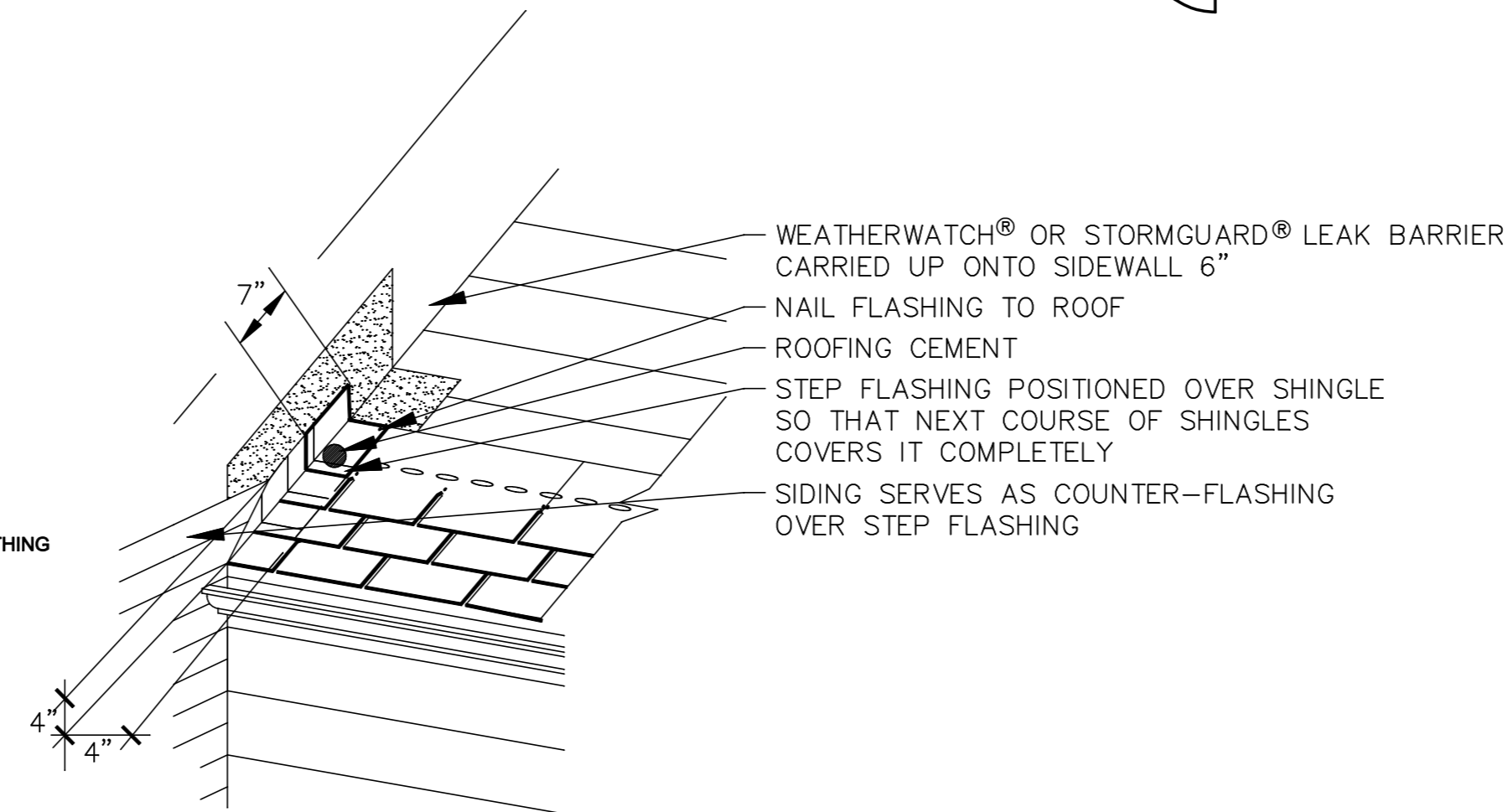

6 STEP FLASHING AGAINST VERTICAL SIDEWALL
A3.6 NTS

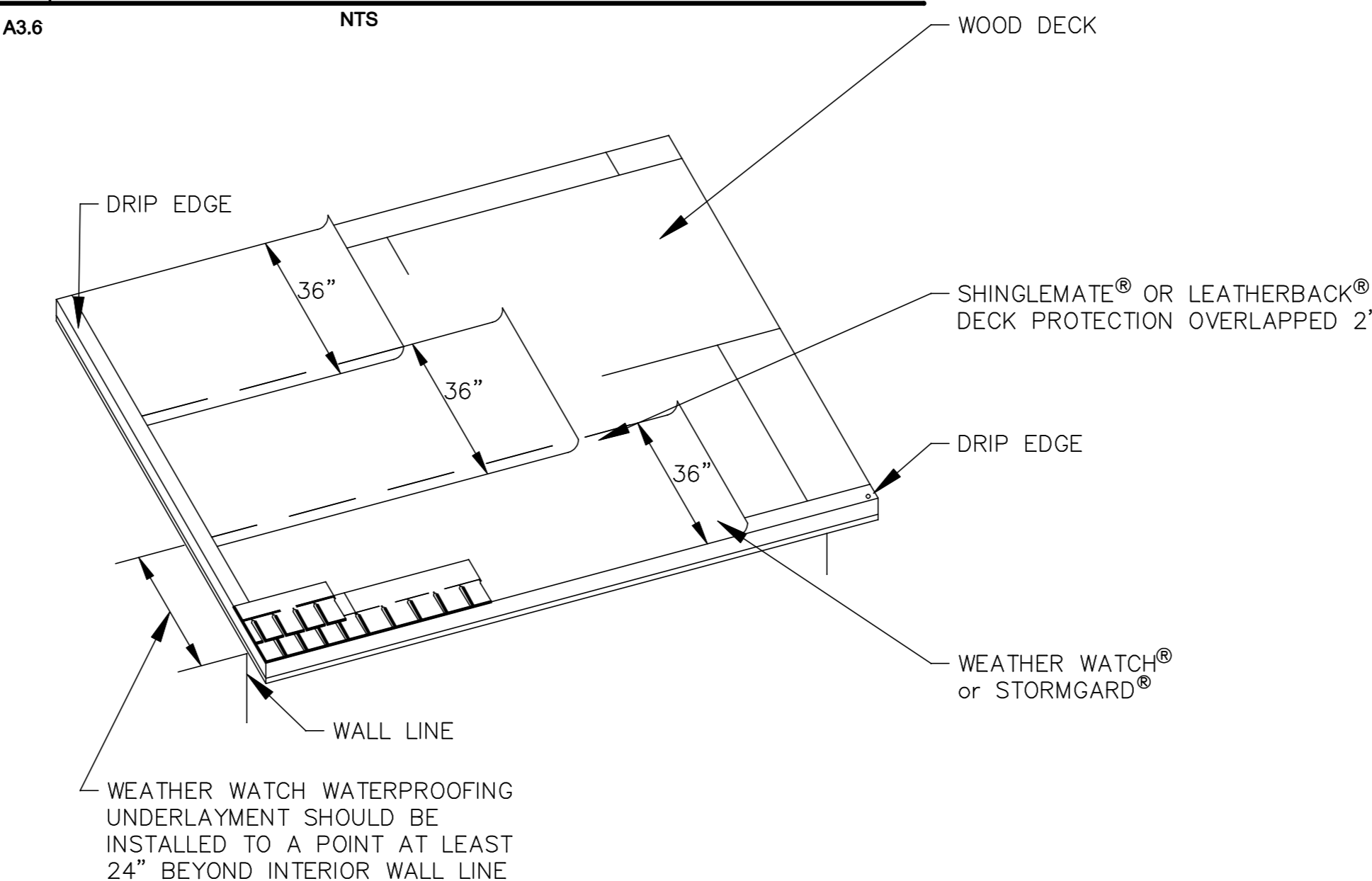

7 UNDERLAYMENT AND STARTER CORSE
A3.6 NTS

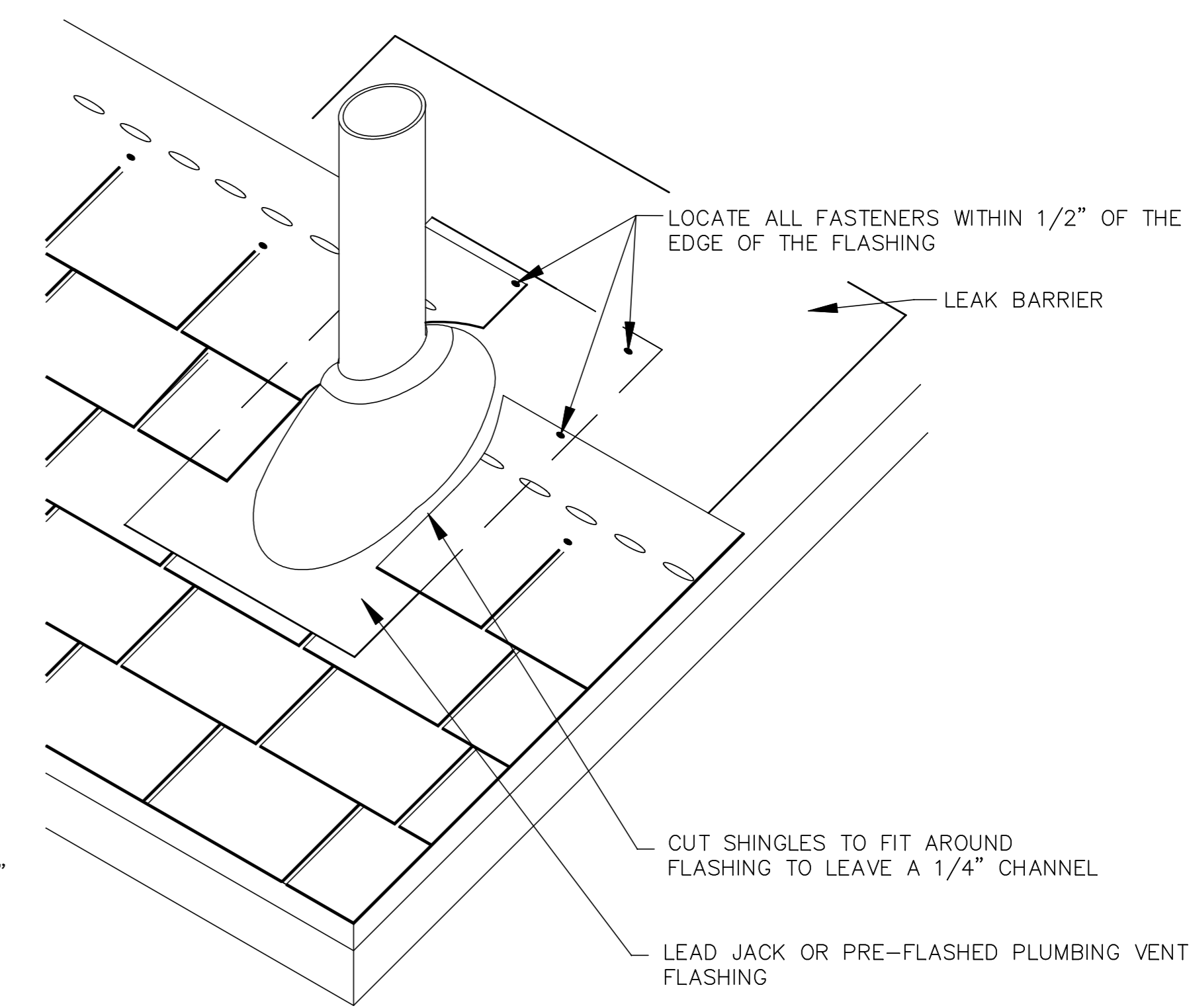

NOTES:
1.) INSTALL 24\"/>

8 PLUMBING VENT FLASHING
A3.6 NTS

revisions

job#: 00104

521 st joseph st renovation
521 st joseph street
new orleans, louisiana
owner:

PRELIMINARY
09-08-2010

A3.6
STEEP SLOPE
ROOF DETAILS

sheet #